



aerospace
climate control
electromechanical
filtration
fluid & gas handling
hydraulics
pneumatics
process control
sealing & shielding



Diesel Fuel Cart

Portable Diesel Fuel Filtration Cart

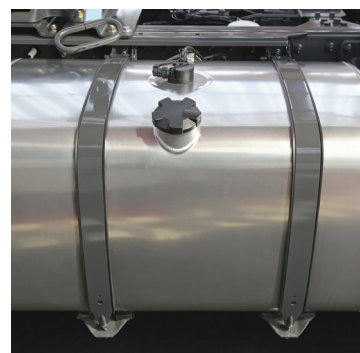

ENGINEERING YOUR SUCCESS.



Therapeutic

- off-line and portable
- provides flexibility for removing water and contaminants from fuel
- improves and extends fuel life and system components



Diesel Fuel Cart

- Filtering new fluid before putting into service
- Transferring fluid from drums or storage tanks to system reservoirs
- Conditioning bulk fluid in storage tanks
- Compliments existing system filtration
- Removes free and emulsified water from a system

Parker's comprehensive asset health management approach extends well beyond traditional methods and brings focus to long term fuel system performance and reliability. Pre-filtration and transfer of diesel and biodiesel fuels is critical in maintaining today's fuel injection systems and extending system component life.

Tight tolerances and higher system pressures require significant improvement in fuel cleanliness and quality. The

Parker Diesel Fuel Cart delivers on the promise of high efficiency removal of harmful contaminants that impact injector life and compromise engine performance. Like most fuels, diesel requires filtration prior to use and after long periods of storage.

The use of the Parker Diesel Fuel Cart is a practical and economical maintenance tool that contributes to optimum engine performance, regardless of application.

Applications

- rail
- mining
- marine
- oil & gas
- agriculture
- transportation
- construction
- stand-by power
- equipment rental locations
- **anywhere diesel fuel is used and/or stored**

Features	Advantages	Benefits
Wide variety of elements available	Meets cleanliness standards	Extends component life and improves system performance
Heavy duty frame	Rugged and durable	Built to last
Lightweight and portable	Easy to move from place-to-place	One operator
Eleven-foot hose and wand assemblies included	Additional hardware not necessary	Ready to use as received



Polished,
clean fuel.





Specifications

Maximum Recommended Fluid

Viscosity:

Diesel – 200 SUS (44 cSt);
0.85 specific gravity

Flow Rate:

16 gpm

Visual Indicator:

15 psid Visual differential

Operating Temperature:

-8.1°C to +66°C (17.5°F to +150°F)

Electrical Service Required:

110/220 volts, 60/50 Hz,
single phase, 9.6/4.8 amps

Electrical Motor:

¾ hp @ 3450 rpm, TEFC

Construction:

Cart frame – Steel
Filter head – Die Cast
Filter bowl – Steel
Hoses – Nitrile
Wands - PVC

Weight:

48.5 kg (107 lbs.)

Dimensions:

A = Height: 1034 mm (40.7 in)
B = Width: 648 mm (25.5 in)
C = Depth: 503 mm (19.8 in)

The DFC polishes the fuel with the Parker FBO-14 filter, which does not require any tools for filter change outs.



Parker's E-Z Form™ MP Series 7219 Hose provides the DFC a flexible, low pressure suction/return hose and vehicle fuel fill connector line specifically made for diesel.

Features and Benefits

Hose & wand assembly:

Parker's E-Z FORM™ MP Series 7219 kink-resistant nitrile hose

Visual indicator:

Tells you when to change element

Heavy Duty frame:

Rugged and built to last

Gear pump:

Parker H Series, long life

Element Service:

FBO-14 fuel filter, which does not require any tools for filter change outs

110V/220V AC motor:

Industrial brand name

Drip tray:

Helps keep the work area safe and clean

Element Performance

New Tier 4 Diesel Engines require finer filtration and better performance.

Typical engine fuel contamination levels, established in 1998 by Worldwide Fuel Charter Committee, required cleanliness of 18/16/13 per ISO 4406. Due to technology advances in High Pressure Common Rail injection systems, the new engines manufactured today require cleanliness levels as low as **12/9/6 or better**. Injector pressures are exceeding 30,000 PSI and smaller nozzle openings are driving the requirements.



The DFC utilizes an industrial rated motor and a Parker H series fixed displacement loaded gear pump which has a high tolerance to system contamination.

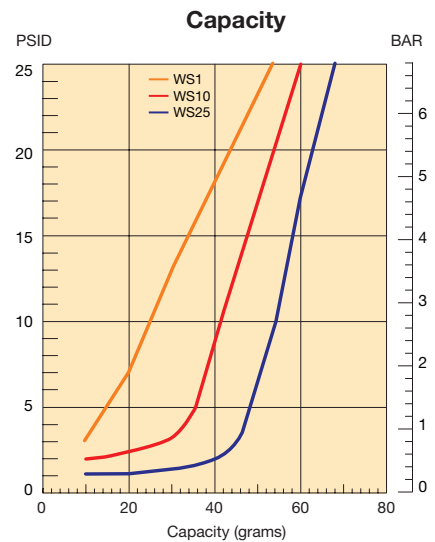
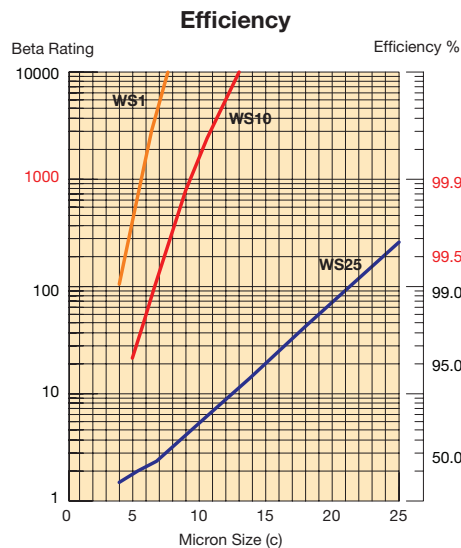

Multi-pass tests run 16 GPM to 25 PSID terminal - 10 mg/L BUGL

Diesel Fuel Cart

Element Choices

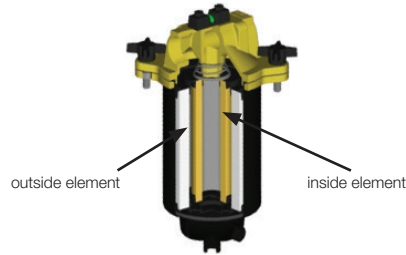

WS

Water separator elements are critical when there is a need to remove both particulate and water contamination from fuels. Testing has shown the WS 25 micron element is capable of achieving >99.5% single pass particulate removal efficiency.

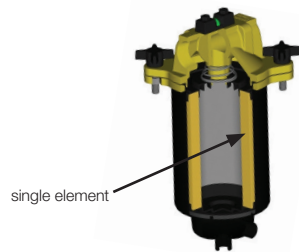

ST

Silicone treated elements are ideal for removing particulate contaminants like dust, dirt, rust, sand, scale etc. from fuels. Testing has shown the ST 25 micron elements are capable of achieving >98.8% single pass particulate removal efficiency.

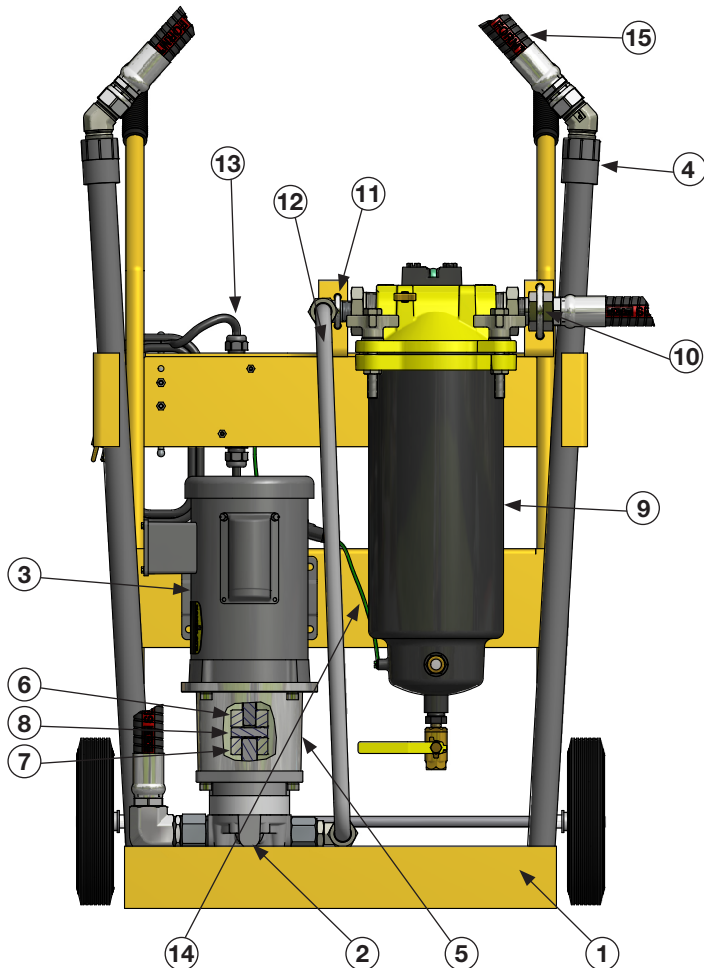

Parts List

Part Number	Description	QTY.
1	945602 DFC CART FRAME ASSEMBLY	1
2	943389 H49 GEAR PUMP H49AAIAV	1
3	945579 3/4 HP MOTOR 3600 RPM 60 hz CFACE	1
4	928784 BUNA WAND	2
5	943042 PUMP ADAPTER	1
6	943087 COUPLING LOVE-JOY L-075.625	1
7	943088 COUPLING LOVE-JOY L-075.750	1
8	943133 SPIDER BUNA L-075	1
9	945513 FILTER HOUSING FBO-14	1
10	945512 U BOLT SS 5/16-18 THD 2-11/16"	1
11	945511 U BOLT SS 1/4-20 THREAD 2"LONG	1
12	945508 TUBE ASSY 3/4 OD 25.11"LONG	1
	928616 HEATER ELEMENT (not shown)	1
13	928617 MANUAL MOTOR STARTER (on back)	1
14	CF DEUTSCH CONNECTOR ASSEMBLY GROUND WIRE	1
15	945582B HOSE ASSY E-Z FORM SERIES 7219	2

CF = Consult Factory

Diesel Fuel Cart

Designed for Diesel and Biodiesel blended fuels only.
Do not use with Gasoline.

Assembly & Operation

Assembly

1. Install hoses to filter by threading the hose end with the straight thread o-ring seal fitting into the pump inlet and filter outlet ports.
2. Connect the PVC tube wands to the swivel fitting on the hose end. When servicing the PVC tube wand, do not over-torque the metal fittings going into the PVC coupling. Over-torque will result in cracking the coupling. Generally, 1/4 turn beyond hand-tight is sufficient.

Operating Instructions

1. Insert the inlet wand assembly into the supply fluid receptacle (drum/reservoir).
2. Insert the outlet wand assembly into the clean fluid receptacle (drum/reservoir).
3. Verify that the ON/OFF switch is OFF and plug the cord into the proper grounded power source (3 wire).
4. Turn switch to ON position and check outlet wand for fuel flow. Allow 30 to 60 seconds for filter to fill with fuel. If repeated attempts to obtain fuel flow fail, check pump inlet fittings for tightness, remove bowl and verify the cover sealing o-ring is in place. It may be necessary to pour 1 or 2 quarts of fluid in to prime pump initially.
5. The condition of the filter element should be monitored by observing the cleanliness indicator on the top of filter. When the indicator is in the CHANGE position filter element **MUST** be replaced.
Warning: Do not restrict the outlet hose with a shut-off valve, causing excessive pressure, which may be harmful to personnel or to the filter cart.
6. The 15 psid cleanliness indicator responds to differential pressure changes and will indicate the condition of the element.
NOTE: The filter cart must be in operation for the indicator to read properly.

Maintenance Instructions

1. Turn switch to OFF position and unplug cord from electrical outlet.
2. Disconnect Deutsch ground wire from bowl. (See #14 on Parts List)
3. Remove tube wands from fuel to prevent siphoning.
4. Open the vent valve on the head to allow the unit to thoroughly vent before loosening the four (4) head knobs.
5. Open the drain valve on the bottom of the housing to allow all fluid to drain from the unit.
6. Loosen the four (4) knobs attached to the head.
7. Remove the head gasket and discard.
8. Remove and discard the expended cartridge; Note: The used cartridge may become a fire hazard, discard in a fire safe place in accordance with all fire safety laws.
9. Flush the interior of the housing with clean, processed, filtered fuel or solvent; Note: A non metallic bristle brush may help remove caked-on debris. Rinse the housing and head with a soft, lint-free cloth.
CAUTION: Due the toxic effects of some additives in filtered fluids, care should be taken in handling the expended cartridge and/or all internal parts that have been in contact with the filtered product.
10. Lightly lubricate the new O-ring with Vaseline or petroleum jelly and position it on the head. If Vaseline is not available, lubricate gasket with clean fuel or clean oil.
11. Insert a new cartridge into the housing. Position housing (with cartridge) underneath filter head. Push/Twist cartridge on to head spigot. The head conical spring will seat/seal the cartridge into the housing.
12. Rotate housing onto the bolts. Hand tighten knobs until head is snug to the housing.
13. Close the vent valve when a small amount of fluid starts to come out.
14. Reconnect Deutsch ground wire to bowl. (See #14 on Parts List)
15. Examine all connections and seals for leaks, shut down immediately if leaks are present.
NOTE: Do not tighten head bolts if unit is pressurized, crack open vent valve to relieve pressure then address leaks.

Troubleshooting

Problem	Cause	Solution
Does not start	ON/OFF Switch	Turn switch ON, replace switch if defective
	No electrical power	Plug in Cart
	Defective motor	Replace
No fuel flow or erratic pump noise	Filter housing not filled with fuel	Allow pump to run 30 to 60 seconds
	Suction Leak	Check tightness of inlet fittings
		Kink or restriction in inlet hose
		Add 1 or 2 quarts of fuel to inlet hose
	Defective Pump	Replace Pump
Indicator Reads BYPASS	Element Dirty	Replace or Clean Element
Indicator does not seem to move	No Element	Install Element
		Check cart model number to verify correct element.

Diesel Fuel Cart

How to Order

Select the desired symbol (in the correct position) to construct a model code. Example:

BOX 1	BOX 2	BOX 3	BOX 4	BOX 5	BOX 6	BOX 7	BOX 8
DFC	14	WS	10	V	V	X	1

BOX 1: Filter Series	
Symbol	Description
DFC	Standard Cart

BOX 2: Model Length	
Symbol	Description
14	Double

BOX 3: Media Code	
Symbol	Description
WS	Water Separator
ST	Silicone Treated

BOX 4: Degree of Filtration	
Symbol	Description
01	1 micron
10	10 micron
25	25 micron

BOX 5: Seals	
Symbol	Description
V*	Fluorocarbon (FKM)

* E-Z Form™ MP 7219 Nitrile Hose

BOX 6: Indicator	
Symbol	Description
V	Differential Visual

BOX 7: Bypass	
Symbol	Description
X	No Bypass

BOX 8: Options	
Symbol	Description
1	None

Replacement Elements

FBO Cartridges	Micron Rating	Water Separator	Silicone Treated
FBO-14	1	945515	945519
	10	945517	945521
	25	945518	945522

Accessories

Part Number	Description
945292	Concentric Wand

Single Point Suction & Return

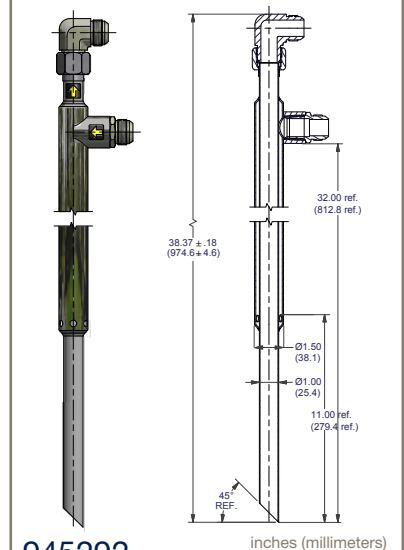

945292

- 1" diameter suction tube
- Fits in openings 1.5 inches and larger
- 32" suction depth
- In-tank filtering
- One port access to the tank
- All steel construction
- Patent pending





ENGINEERING YOUR SUCCESS.



Hydraulic & Fuel Filtration Division

Your prescription for total system health.



Dedicated to the long term health and reliability of mission critical assets, Parker Hydraulic & Fuel Filtration Division offers you innovative products that cover your diagnostic, therapeutic and preventive needs.

Total System Health Management



Diagnostic - Monitors - Detects - Alerts

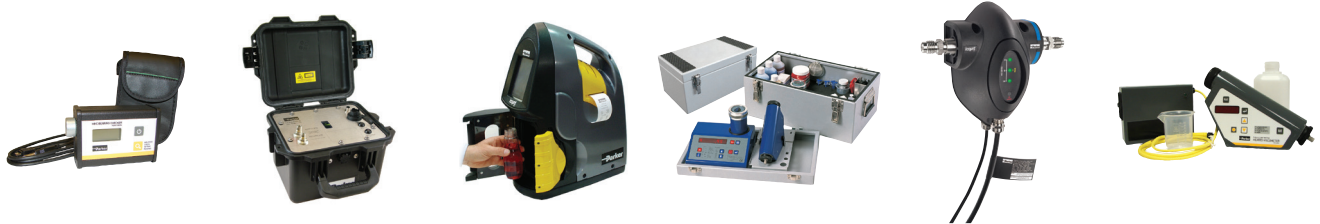

Therapeutic - Supports - Improves - Fortifies



Preventive - Long Term Defense / Value - Reduced Cost of Ownership



Your Trusted Partner
in Total System
Health Management



Worldwide Filtration Manufacturing Locations

North America

Compressed Air Treatment Filtration & Separation/Balston

Haverhill, MA
978 858 0505
www.parker.com/balston

Finite Airtek Filtration Airtek/donnick hunter/Zander

Lancaster, NY
716 686 6400
www.parker.com/faf

Finite Airtek Filtration/Finite

Oxford, MI
248 628 6400
www.parker.com/finitefilter

Engine Filtration & Water Purification Racor

Modesto, CA
209 521 7860
www.parker.com/racor

Holly Springs, MS
662 252 2656
www.parker.com/racor

Beaufort, SC
843 846 3200
www.parker.com/racor

Village Marine, Sea Recovery, Horizon Reverse Osmosis

Carson, CA
310 637 3400
www.parker.com/watermakers

Hydraulic Filtration Hydraulic Filter

Metamora, OH
419 644 4311
www.parker.com/hydraulicfilter

Laval, QC Canada
450 629 9594
www.parkerfarr.com

Process Filtration donnick hunter Process Filtration

Oxnard, CA
805 604 3400
www.parker.com/processfiltration

Madison, WI
608 824 0500
www.scilog.com

Phoenixville, PA
610 933 1600
www.parker.com/processfiltration

Aerospace Filtration Velcon Filtration

Colorado Springs, CO
719 531 5855
www.velcon.com

Europe

Compressed Air Treatment donnick hunter Filtration & Separation

Gateshead, England
+44 (0) 191 402 9000
www.parker.com/dhfn

Parker Gas Separations

Etten-Leur, Netherlands
+31 76 508 5300
www.parker.com/dhfn

Hiross Zander

Padova Business Unit
Padova, Italy
+39 049 9712 111
www.parker.com/hz

Hiross Zander

Essen Business Unit
Essen, Germany
+49 2054 9340
www.parker.com/hz

Engine Filtration & Water Purification Racor

Dewsbury, England
+44 (0) 1924 487 000
www.parker.com/rfde

Racor Research & Development

Stuttgart, Germany
+49 (0)711 7071 290-10
www.parker.com/rfde

Hydraulic Filtration Hydraulic Filter

Arnhem, Holland
+31 26 3760376
www.parker.com/hfde

Ujala Operation

Ujala, Finland
+358 20 753 2500
www.parker.com/hfde

Condition Monitoring Centre

Norfolk, England
+44 (0) 1842 763 299
www.parker.com/hfde

Parker Kittiwake

West Sussex, England
+44 (0) 1903 731 470
www.kittiwake.com

Parker Procal

Peterborough, England
+44 (0) 1733 232 495
www.kittiwake.com

Process Filtration donnick hunter Process Filtration

Birtley, England
+44 (0) 191 410 5121
www.parker.com/processfiltration

Parker Twin Filter BV

Zaandam, Netherlands
+31(0)75 655 50 00
www.twinfilter.com

Asia Pacific

Australia

Castle Hill, Australia
+61 2 9634 7777
www.parker.com/australia

China

Shanghai, China
+86 21 5031 2525
www.parker.com/china

India

Navi Mumbai, India
+91 22 651 370 8185
www.parker.com/india

Parker Fowler

Bangalore, India
+91 80 2783 6794
www.johnfowlerindia.com

Japan

Tokyo, Japan
+81 45 870 1522
www.parker.com/japan

Parker Techno

Osaka, Japan
+81 66 340 1600
www.techno.taiyo-ltd.co.jp

Korea

Hwaseon-City
+82 31 359 0852
www.parker.com/korea

Singapore

Jurong Town, Singapore
+65 6887 6300
www.parker.com/singapore

Thailand

Bangkok, Thailand
+66 2186 7000
www.parker.com/thailand

Latin America

Parker Comercio Ltda. Filtration Division

Sao Paulo, Brazil
+55 12 4009 3500
www.parker.com/br

Pan American Division

Miami, FL
305 470 8800
www.parker.com/panam

Africa

Aeroporto Kempton Park, South Africa
+27 11 9610700
www.parker.com/africa

